



INNOVATIVE WATERMAKERS

Marine Brochure



Sea Recovery - The trusted source for fresh water

Sea Recovery has manufactured the most innovative and intuitive watermakers for the past 30 years. By incorporating a customer-first philosophy into our designs, the quality of our products is never compromised. We believe that boaters deserve more from their watermakers. Dealing with confusing controls and maintenance should not be a concern. Our company strives to communicate to the heart of the leisure boater, by engineering systems that marries style with functionality, a formula that has made Sea Recovery the #1 watermaking brand among marine consumers and boat builders around the world.

Service and support

Worldwide Dealer Network

With hundreds of certified dealers throughout the world, Sea Recovery customers can cruise confidently to any destination and expect a friendly Sea Recovery expert ready to service or upgrade their system.

Sea Recovery Warranty Coverage*

We stand behind our innovative products by providing our customers a full year warranty that includes full coverage for parts and labor at no extra cost to you.

Quality is our Priority

Safety and quality standards are priority and our goal is to surpass them. Our products utilize quality parts and are built to withstand any condition.

* Refer to your owner's manual for warranty details.

Sea Recovery is certified by the following associations:



ISO 14001:2004



ISO 9001:2008



ABS Type Approved, ISO 14001:2004, and ISO 9001:2008 by ABS.

Safety, service, and solutions are the goals that define the American Bureau of Shipping. Sea Recovery is the first and only watermaker manufacturer to gain full product line type acceptance.

National Marine Manufacturers Association and Southern California Marine Association

Sea Recovery is an active member in the above associations in good standing.

CE Approval

The Conformité Europééne (CE) mark indicates that our products comply with the legal standards of the EU directives.

Did you know?



You can increase the value of your boat up to 10% by washing down your boat with Sea Recovery product water.



Sea Recovery water has superior taste than your regular tap. Even coffee made with Sea Recovery water tastes better.



You can create clear ice cubes with Sea Recovery water. Store any food, including fish of the day with Sea Recovery water ice for better preservation.

Enjoy the Benefits of a Sea Recovery Watermaker...

Less weight, lower fuel costs, higher speeds

Cruising with a full water tank, or an extra 1,700 pounds will result in wasted fuel, slower speeds, and shorter trips. A Sea Recovery watermaker allows you to cruise faster and farther and create fresh water... on location. Our systems save boaters time and money, while maximizing yacht performance.

Cruise without limits or boundaries

With a Sea Recovery watermaker, you don't need to plan your boating activities around marina stops. Cruise direct to your destination or cruise to limitless distances without the need to stock up on fresh water.

Fresh water wash downs

Wash downs with Sea Recovery water are highly effective in preserving your yacht's exterior, which can contribute to an increase to the value of your yacht. Sea Recovery water acts as a sponge, absorbing and washing out all unwanted sea salt and minerals, and dries clean - without any water spots.

Convenient for every boating activity

Whether you use it to drink, shower or to wash down your yacht, owning a Sea Recovery watermaker provides unlimited possibilities that saves money and increases leisure time. How can any boater afford not to own a Sea Recovery watermaker?

Table of Contents

NMEA 2000 P03 **NEW FEATURES** P04

Yacht Category:

Mid to Large

(40 - 80 feet / 12 - 24 meters)



AQUA MATIC P05

SPECIFICATIONS P07 **DIMENSIONS** P08

AQUA WHISPER DX P09 **AQUA WHISPER PRO** P11

SPECIFICATIONS P13 **DIMENSIONS** P14

Yacht Category:

Mega

(over 80 feet / 24 meters)



CORAL SEA C-2 SERIES P21

SPECIFICATIONS P23

DIMENSIONS / ACCESSORIES P24

Yacht Category:

Sail Boats / Small Power Boats

(30 - 45 feet / 9 - 14 meters)



AQUA WHISPER MINI P15 **ULTRA WHISPER** P17

SPECIFICATIONS P19

DIMENSIONS P20

MARINE ACCESSORIES P25

CONSUMABLES AND SPARES P26

GENERAL SYSTEM SPECIFICATIONS P26

NMEA 2000 - No more engine room visits

Sea Recovery's new line of watermakers are NMEA 2000 compliant, giving boaters the power to monitor and communicate with their systems through any NMEA 2000 compatible display.*

NMEA 2000 Network

Eliminate wires, clutter, and engine room visits by connecting directly to your NMEA 2000 central connection. This network standard allows boaters to monitor all NMEA-compliant electronics through their system displays installed throughout your yacht or laptop.



Tower Display



Radar



Aqua Matic Remote Display



Flybridge and GPS Display

*Check with your display manufacturer for compatibility

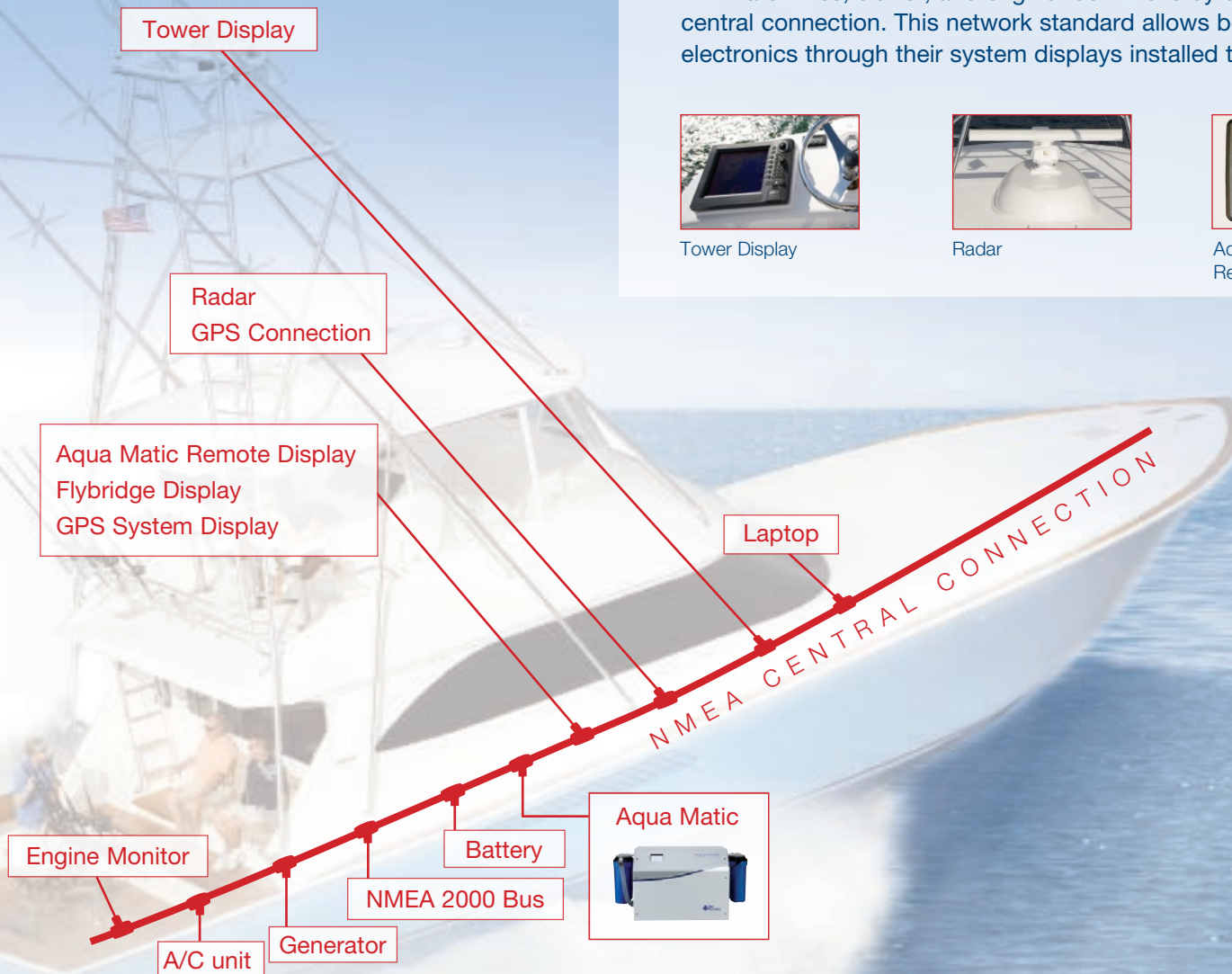

Quality tested for smooth functionality

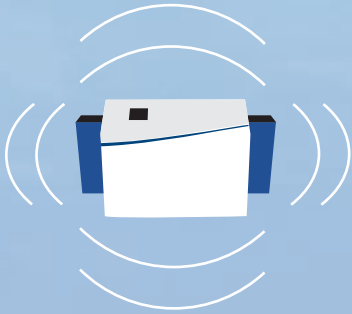

Engineered for less noise pollution

Sea Recovery watermakers feature state of the art frames that optimize space, minimize sound, and reduce maintenance time. Sound has been noticeably reduced by 3db for the Aqua Matic and Aqua Whisper DX systems.

Vibration tested

Our systems are manufactured and tested to withstand up to 20 G's of continuous force for over an hour of operation, ensuring reliable performance in all conditions.

State of the art color touch screen

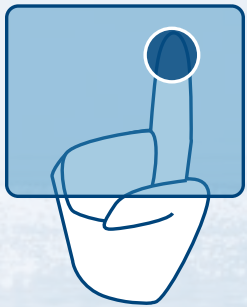

User-friendly touchscreen

Our full color LCD touch screens are designed to be simple and easy to use. Featuring an intuitive Human Machine Interface navigation menu, system start-up and controls are able to be activated with a single touch.

Customized display settings

Equipped with a multiple language interface, you can choose to display your screen in English, French, Italian, and Spanish. You also have the choice to set measurement units to either metric or US standard readings.

More water, less clutter

Sea Recovery watermakers create more water per square inch than any other system in the world. By utilizing high efficiency membranes, there is 17% more filtering surface area than conventional membranes. This reduces the amount of membranes and installation space required by competing brands.

Ex. 1: Sea Recovery's 700 gallon capacity membranes are smaller in length, about the same in diameter, yet have a larger filtering surface than the generic 600 gallon membrane.

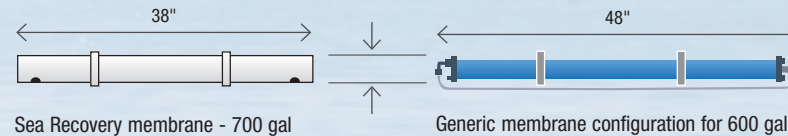

Ex 2: Sea Recovery's 1400 gallon membrane configuration uses less membranes than the generic 1200 gallon membrane configuration, giving you more filtering surface while reducing replacement and maintenance costs.

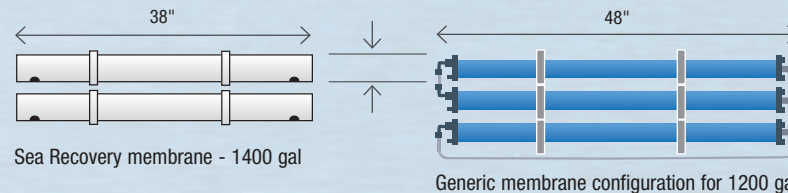

AQUA MATIC

Be Innovative, Be Adventurous

The revolutionary Aqua Matic is engineered to be easier to use and more reliable than conventional watermakers. Featuring the latest technology, the Aqua Matic is able to regulate and monitor system functions without the need of an operator. With one touch, the Aqua Matic will start and finish water production automatically, allowing boaters more time to relax and enjoy their cruise.



Modular Configuration



Aqua Matic Key Features

- NMEA 2000 compliant
- Full color touch screen
- One touch operation
- Quiet high pressure pump



Category | Mid to Large Yachts (40 - 80 ft / 12 - 24 m)



Automated functions

Standard watermakers require pressure adjustments for water conditions and to produce fresh water - a process that can be very time consuming. Sea Recovery solves this problem by incorporating an automatic pressure regulating system into the Aqua Matic, allowing the watermaker to balance pressure levels automatically. This feature is designed to maximize a boater's comfort and convenience, allowing more time to be invested in leisure activities.

< Push start and the Aqua Matic does the rest



Longer lifespan with minimal maintenance

The Aqua Matic's features allow boaters to extend its service life. The automatic Fresh Water Flush and LCD monitoring system allows you to optimize pre-filter and membrane performance. This system will flush every 7 days, whether the watermaker is producing water or on standby. Also equipped with the Aqua Matic is a standard high pressure plunger pump (optional radial axial pump upgrade available) that operates at low noise levels and requires minimal maintenance.

< System Status Information



Courtesy of Viking Yachts

The best technology that accommodates your needs

Equipped with every Aqua Matic is an exclusive color LCD touch screen that simplifies system monitoring and operation with easy to view displays. Functions and controls are available anywhere throughout the NMEA 2000 network, and are quickly configured with a single touch of the menu. The screen also reminds you of any maintenance needs and if performance or water quality falls below a determined level. With a Full-Color Alert System, boaters will be quickly advised to tend to any maintenance issue, to ensure that your system continues to run optimally.

Specifications - Aqua Matic

	Model #	Production/hr.	Production/24hrs.	Weight - Compact*	Weight - Modular*
PRODUCTION & WEIGHT	450-1	19 Gal / 71 L	450 Gal / 1,703 L	153 lbs / 69 kg	149 lbs / 68 kg
	700-1	29 Gal / 110 L	700 Gal / 2,650 L	156 lbs / 71 kg	152 lbs / 69 kg
	900-1	38 Gal / 142 L	900 Gal / 3,407 L	158 lbs / 72 kg	154 lbs / 70 kg
	900-2	38 Gal / 142 L	900 Gal / 3,407 L	165 lbs / 75 kg	161 lbs / 73 kg
	1400-2	58 Gal / 221 L	1,400 Gal / 5,300 L	171 lbs / 76 kg	167 lbs / 76 kg
	1800-2	75 Gal / 284 L	1,800 Gal / 6,814 L	176 lbs / 80 kg	172 lbs / 78 kg

* Weights based on single phase motor. For three phase motors subtract 9 lbs.

ELECTRICAL	Phase	Pump Motor	Voltage VAC	Hz	Normal Operating Amps	Start Up Current
Plunger Pump Radial Axial Pump	Single	High Pressure / Booster	110-115 / 220 -230	50 / 60	110 / 220 30 / 15	110 / 220 100 / 50
	Single	High Pressure / Booster	110-115 / 220 -230	50 / 60	35 / 17.5	110 / 55
Plunger Pump Radial Axial Pump	Three	High Pressure / Booster	220-230 / 380-460	50 / 60	220 / 380 - 440 11 / 5.5	220 / 380 - 460 30 / 15
	Three	High Pressure / Booster	220-230 / 380-460	50 / 60	11 / 5.5	30 / 15

Circuit Breaker Size	Operating AC Voltage	Phase	Recommended circuit breaker
Plunger Pump Radial Axial Pump	110-115 / 220-230	Single	40 Ampere / 20 Ampere
Plunger Pump Radial Axial Pump	220 / 380 / 460	Three	15 Ampere / 10 Ampere / 10 Ampere
Plunger Pump Radial Axial Pump	220 / 380 / 460	Three	15 Ampere / 10 Ampere / 10 Ampere

Dimensions

AQUA MATIC

COMPACT

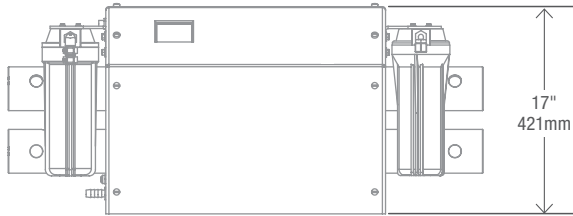

Compact System - Front

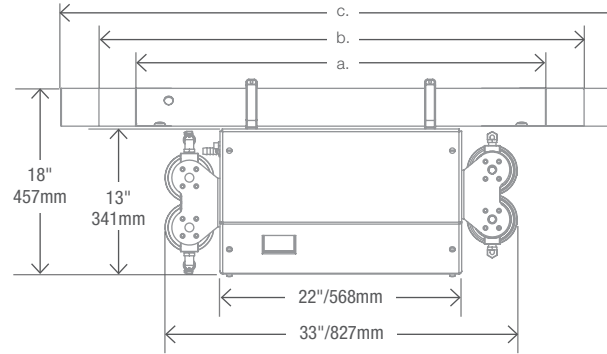

Overhead

Membranes Vessels:

- a. 27 15/16" (710mm): Aqua Matic Compact 450-1 & 900-2
- b. 37 15/16" (964mm): Aqua Matic Compact 700-1 & 1400-2
- c. 46 15/16" (1192mm): Aqua Matic Compact 900-1 & 1800-2

MODULAR

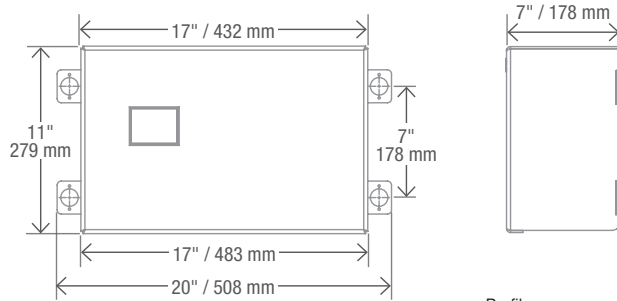

Control Panel - Front

Profile

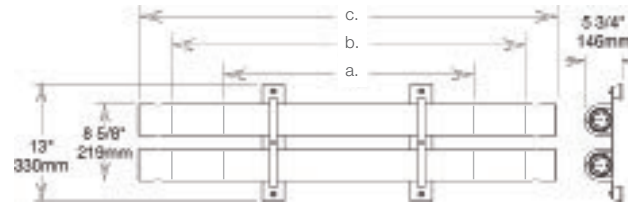

Double R.O. Membrane Vessel Assembly

Membranes Vessels:

- a. 27 15/16" - 710mm: SRC Aqua Matic Modular 450-1 & 900-2
- b. 37 15/16" - 964mm: SRC Aqua Matic Modular 700-1 & 1400-2
- c. 46 15/16" - 1192mm: SRC Aqua Matic Modular 900-1 & 1800-2

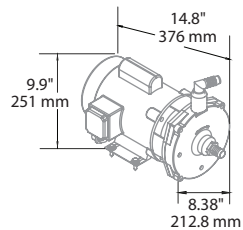

Booster Pump

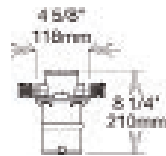

Sea Strainer

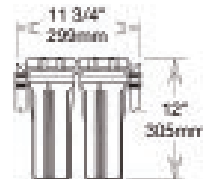

Dual Pre-filter &
Dual Post Filter

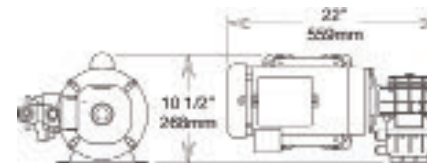

Standard Plunger Pump

WATER CONNECTIONS: Feed Water 3/4", Brine Discharge 3/4", Product Water 1/2"

AQUA WHISPER DX

Be completely in control

The Aqua Whisper DX grants boaters the freedom to monitor and regulate system capabilities. Made for the hands-on boater, the Aqua Whisper DX allows you to customize features and pressure settings with an advanced touch screen display. It's ruggedness and reliability allows boaters to confidently command their watermaker in all parts of the world.



Modular Configuration



Aqua Whisper DX Key Features

- NMEA 2000 compliant
- Digital menu
- User adjusted operation
- Quiet performance



Category | Mid to Large Yachts (40 - 80 ft / 12 - 24 m)

Semi-automatic functions

Sea Recovery has combined the best of both worlds in the semi-automated Aqua Whisper DX reverse osmosis desalinator. For those who prefer the security of manual control, but enjoy the convenience of enhanced automatic operation, the Aqua Whisper DX provides a hands-on programmable system, with walk away automation after.



Maximize system settings

With the Aqua Whisper DX, you have the power to manually optimize and configure your system settings according to any water condition you encounter. Pressure and temperature is balanced using a pressure regulating knob (shown left), allowing boaters to operate the Aqua Whisper DX in any ocean condition. Operations are easily optimized in seconds simply by turning the knob to your preferred setting.



Pressure Status

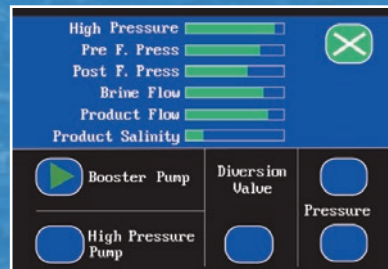

Manual Drive

Manage critical functions from any location

The LCD touch screen acts as your watermaker's first mate, and will assist your efforts to maintain, guide, and configure the Aqua Whisper DX anyway you wish. Vital system functions and gauges are reported through the display and remote, and can be accessed at any time. The Aqua Whisper DX gives operators maximum control with the ability to do more than ever before.

AQUA WHISPER_{PRO}

For the hands-on boater

The Aqua Whisper Pro watermaker is suited for charter, offshore fishing, and ocean cruising. It's traditional manual functions and touch-pad control panel allows simple operation and digital + analog instrumentation for redundancy. The Aqua Whisper Pro's high pressure pump is engineered to be quieter than conventional high pressure pumps, and operates for 2,500 hours before any maintenance is required.



Modular Configuration



Aqua Whisper PRO Key Features

- Automatic FWF on frame
- Automatic shutdown option
- Small footprint
- Robust, failsafe design



Category | Mid to Large Yachts (40 - 80 ft / 12 - 24 m)

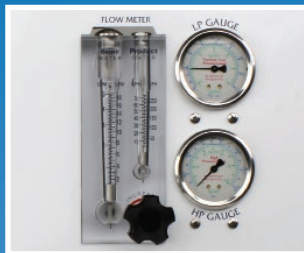

Easy to use, easy to upgrade

The Aqua Whisper Pro's semi-automatic operation requires only one pressure adjustment to varying feed water conditions. User-friendly touch pad control panel is simple to use and easy to understand. Multiple product water production capabilities from 450 gallons / 1,703 liters to 1800 gallons / 6,814 liters per day (19 gal / 71 lit - 75 gal / 284 lit per hour). All Aqua Whisper Pro models are "in-field" upgradable to higher production capacities.

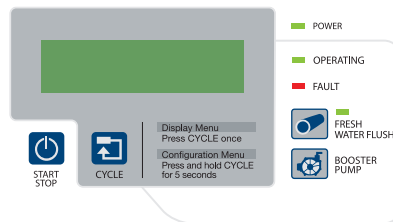

Optional Settings:

- Auto-start on Tank Empty Level Signal
- Auto-stop on Tank Full Level Signal
- Auto-stop Timer - Five Pre-Defined
- Auto-Shutdown Countdown Times

Manage critical functions from any location

The LCD touch screen acts as your watermaker's first mate, and will assist your efforts to maintain, guide, and configure the Aqua Whisper Pro anyway you wish. Vital system functions and gauges are accessible through the display and remote, and can be accessed at any time. The Aqua Whisper Pro gives operators maximum control with the ability to do more than ever before.



Fresh Water Flush on frame

The AQW Pro compact features all replaceable pre and post filters on frame, for the easiest installation and operation, including the carbon filter for the fresh water flush that comes standard. Alternatively, for the more intense applications like i.e. dirty sea water, charter cruises, offshore fishing or ocean crossings, the AQW Pro is available with heavier duty commercial pre-filter and oil water separator in place of the standard pre-filters on frame, for longer lasting cartridges and less frequent replacement.

Specifications - Aqua Whisper DX / Aqua Whisper PRO

	Model #	Production/hr.	Production/24hrs.	AW DX compact*	AW DX modular*	AW PRO compact*	AW PRO modular*
PRODUCTION & WEIGHT	450-1	19 Gal / 71 L	450 Gal / 1,703 L	157 lbs / 71 kg	153 lbs / 69 kg	157 lbs / 71 kg	153 lbs / 69 kg
	700-1	29 Gal / 110 L	700 Gal / 2,650 L	160 lbs / 73 kg	156 lbs / 71 kg	160 lbs / 73 kg	156 lbs / 71 kg
	900-1	38 Gal / 142 L	900 Gal / 3,407 L	162 lbs / 73 kg	158 lbs / 72kg	162 lbs / 73 kg	158 lbs / 72kg
	900-2	38 Gal / 142 L	900 Gal / 3,407 L	169 lbs / 77 kg	165 lbs / 75 kg	169 lbs / 77 kg	165 lbs / 75 kg
	1400-2	58 Gal / 221 L	1,400 Gal / 5,300 L	175 lbs / 79 kg	171 lbs / 76 kg	175 lbs / 79 kg	171 lbs / 76 kg
	1800-2	75 Gal / 284 L	1,800 Gal / 6,814 L	180 lbs / 82 kg	175 lbs / 79 kg	180 lbs / 82 kg	175 lbs / 79 kg

* Weights based on single phase motor. For three phase motors subtract 9 lbs.

ELECTRICAL	Phase	Pump Motor	Voltage VAC	Hz	Normal Operating Amps	Start Up Current
Plunger Pump	Single	High Pressure / Booster	110-115 / 220 -230	50 / 60	110 / 220 30 / 15	110 / 220 100 / 50
	Three	High Pressure / Booster	220-230 / 380-460	50 / 60	220 / 380 - 440 11 / 5.5	220 / 380 - 460 30 / 15

Circuit Breaker Size	Operating AC Voltage	Phase	Recommended circuit breaker
Plunger Pump	110-115 / 220-230	Single	40 Ampere / 20 Ampere
	220 / 380 / 460	Three	15 Ampere / 10 Ampere / 10 Ampere

Dimensions

AQUA WHISPER DX

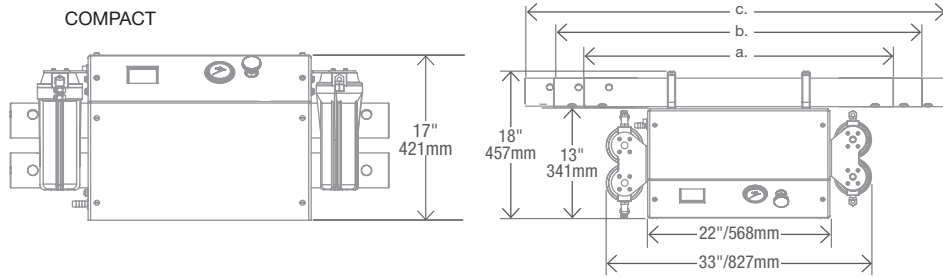

AQUA WHISPER PRO

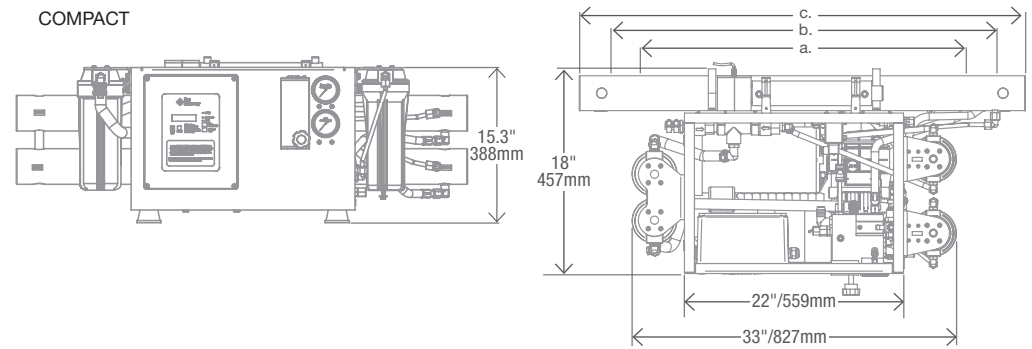

- a. 27 15/16" (710mm): Aqua Whisper DX / PRO Compact 450-1 & 900-2 b. 37 15/16" (964mm): Aqua Whisper DX / PRO Compact 700-1 & 1400-2
 c. 46 15/16" (1192mm): Aqua Whisper DX / PRO Compact 900-1 & 1800-2

AQUA WHISPER DX MODULAR

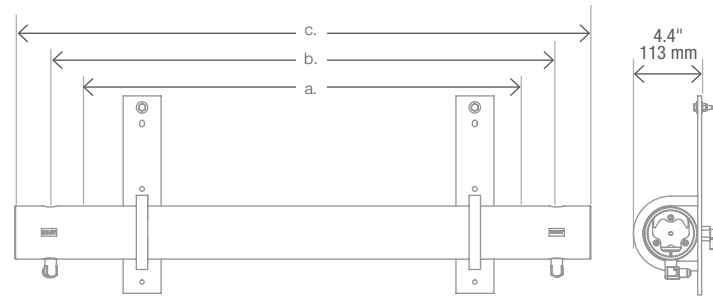
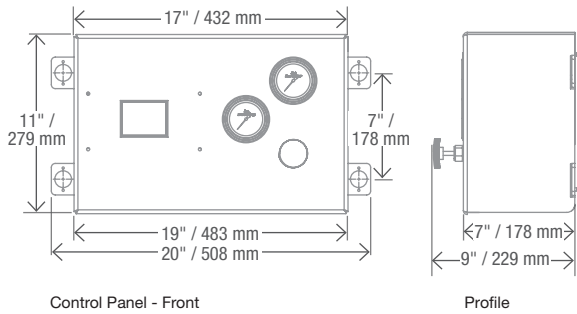

Double R.O. Membrane Vessel Assembly

- a. 27 15/16" - 710mm: Aqua Whisper DX/PRO Modular 450-1 & 900-2
 b. 37 15/16" - 964mm: Aqua Whisper DX/PRO Modular 700-1 & 1400-2
 c. 46 15/16" - 1192mm: Aqua Whisper DX/PRO Modular 900-1 & 1800-2

AQUA WHISPER PRO MODULAR

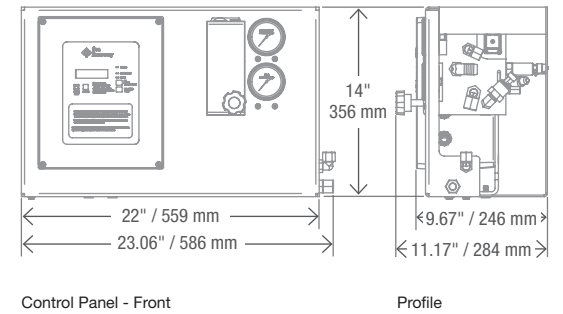

AQUA WHISPER DX / PRO Pumps & Filters

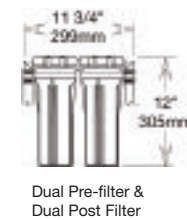
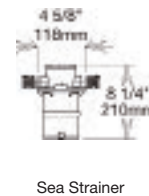
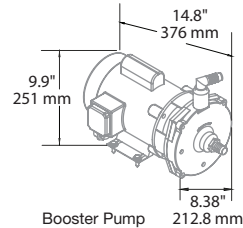
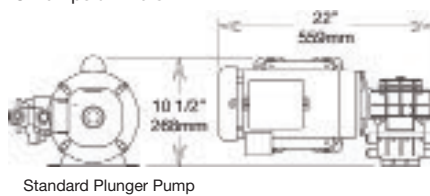

WATER CONNECTIONS: Feed Water 3/4", Brine Discharge 3/4", Product Water 1/2"

AQUA WHISPER MINI

Great things come in small packages

The low-hassle Aqua Whisper Mini is engineered to fit anywhere. Measuring at about 2 - 3 cubic feet, sail and small power boaters have the opportunity and the convenience of a Sea Recovery watermaker without space restrictions. Featuring a simple interface, the Aqua Whisper Mini can be monitored via the control panel or remote (optional). The Aqua Whisper Mini can produce up to 7, 15, 23, or 31 gallons of fresh water per hour and is the perfect seaworthy companion for the solo cruiser.



Modular Configuration



Aqua Whisper Mini Key Features

- Smallest line of watermakers
- Easy access to main components
- Low AC power consumption
- Maximum system weight is 150 lbs



Category | Small Power Boats & Sailboats (35 - 45 ft / 10 - 14 m)

Smaller than a 34 gallon water tank, up to 750 gallons in capacity

The Aqua Whisper Mini is a few cubic inches smaller than a 20 gallon water tank, yet is capable of producing between 170 and 750 gallons of potable water per day. Weighing at most, 130 lbs, the Aqua Whisper Mini is also more convenient than hauling around a full water tank that adds about 8 pounds per gallon to your boat. For example, if you filled up a 34 gallon tank to capacity, you will have to haul about 342 lbs, which will put more stress on your engine, slow down your speed, and increase fuel costs. With the Aqua Whisper Mini, compact boaters will carry minimal weight, save space, and cruise without limits to any destination they wish.

Aqua Whisper Mini 170



12" L x 17" W x 15" D

System Weight = 70 lbs

Water Weight = 0 lbs
(make water on location)

Total weight = 70 lbs

36 Foot Sailboat

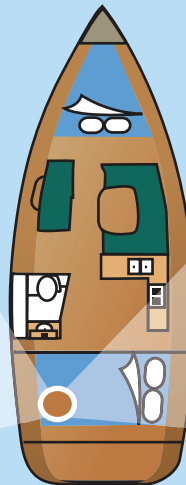

34 Gallon Water Tank



34" L x 26" W x 10" D

Tank Weight = 70 lbs

Water Weight = 272 lbs

Total weight = 342 lbs

* An Aqua Whisper Mini 170 is smaller, lighter, and has a higher capacity than the average 34 gallon tank.

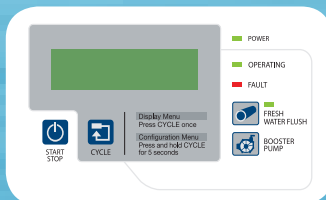

Unlimited features at your control

The Aqua Whisper Mini controller provides fresh water flush options, better maintenance access, and safety alarm features. With the most stable controller in the market, the Aqua Whisper Mini keeps up its reputation as the smallest, most reliable watermaker used by boaters around the world.

ULTRA WHISPER

The low power alternative

The Ultra Whisper is engineered for boaters with limited electrical options. With its new low powered Energy Transfer Device, the very quiet Ultra Whisper is more efficient and requires less maintenance than before. Featuring automatic operation and easy to use Start and Stop controls, the Ultra Whisper is capable of producing between 8 and 25 gallons per hour, ideal for small power boats and sail boats.



Modular Configuration



Ultra Whisper Key Features

- AC or DC power
- Energy efficient
- Worry-free operation
- Quiet operation



Category | Small Power Boats & Sailboats (35 - 45 ft / 10 - 14 m)

25 GPH available in 24 VDC

The Ultra Whisper replaces the high pressure pump with the Energy Transfer Device. The Energy Transfer Device's patented design produces water through a two valve flow system that delivers smooth, constant, fault-free, automatic operation with no valves to adjust.

Energy efficient & connects to your AC or DC power

With the Ultrawhisper's low power technology, boaters get more out of minimal power. The new Energy Transfer Device and the Ultra Whisper's efficient functions are capable of reducing power consumption by up to 75%. Giving you more out of your energy source and allowing you to travel worry-free.



Energy Transfer Device

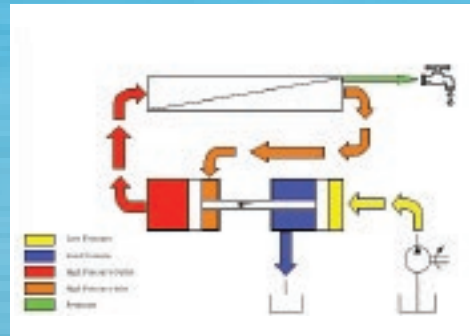

Smallest energy recovery device in the market.



Photo courtesy of Admiral Yachts

Specifications - Aqua Whisper Mini / Ultra Whisper

MODEL	Production / Hr.	Production / 24Hrs.	Weight - Compact	Weight - Modular	MODEL	Production / Hr.	Production / 24Hrs.	Weight - Compact	Weight - Modular
AQW MINI 170	7 gal / 27 L	170 gal / 644 L	70 lbs / 32 kg	70 lbs / 32 kg	AQW MINI 550	23 gal / 87 L	550 gal / 1,900 L	142 lbs / 64 kg	128 lbs / 57 kg
AQW MINI 350	15 gal / 55 L	350 gal / 1,325 L	127 lbs / 58 kg	89 lbs / 40 kg	AQW MINI 750	31 gal / 117 L	750 gal / 2,850 L	150 lbs / 68 kg	130 lbs / 59 kg

ELECTRICAL	Phase	Pump Motor	Voltage	Hz	H.P.	Normal Operating Amps	Start Up Current
AQW MINI 170	N / A	High Pressure	12 / 24	N / A	.33	29 / 14	90 / 45
	Single	High Pressure	110 / 230	50 / 60	.33	6 / 3	26 / 13
AQW MINI 350	Single	High Pressure	110 / 230	50 / 60	1	13 / 6.5	52 / 26
AQW MINI 550 & 750	Single	High Pressure	110 / 220	50 / 60	2.1	26 / 13	93 / 47
	Single	Booster	110 / 220	50 / 60	0.5	7 / 3.5	28 / 14

Circuit Breaker Size	Operating Voltage	Phase	Recommended circuit breaker	Circuit Breaker Size	Operating Voltage	Phase	Recommended circuit breaker
AQW MINI 170	12 / 24 VDC	Single	40 Ampere / 20 Ampere	AQW MINI 550	110 (AC)	Single	40 Ampere
	110 / 230 (AC)		12 Ampere / 10 Ampere	AQW MINI 750	220 (AC)	Single	20 Ampere
AQW MINI 350	110 / 230 (AC)	Single	20 Ampere / 15 Ampere				

SYSTEM	Model #	Production / Hr.	Weight - Compact	Weight - Modular	ELECTRICAL	Feed Pump and Motor	VAC	NOA	SUC
ULTRA WHISPER	200	8.3 gal / 32 liters	130 lbs / 59 kg	125 lbs / 59 kg	ULTRA WHISPER 200	12V		24	58
	400	16.5 gal / 63 liters	145 lbs / 66 kg	140 lbs / 63 kg		24V		12	29
						Phase HZ			
600	25 gal / 95 liters	155 lbs / 70 kg	150 lbs / 68 kg	Single 50 / 60	115	4.8 / 5.0	26		
				Single 50 / 60	230	2.4 / 2.5	13		
ULTRA WHISPER 400	400	16.5 gal / 63 liters	145 lbs / 66 kg	140 lbs / 63 kg	ULTRA WHISPER 400	12V		26	77
						24V		13	38
						Phase Hz			
600	25 gal / 95 liters	155 lbs / 70 kg	150 lbs / 68 kg	Single 50 / 60	115	5.1 / 5.3	26 / 25		
				Single 50 / 60	230	2.5 / 2.7	13 / 12.5		
ULTRA WHISPER 600	600	25 gal / 95 liters	155 lbs / 70 kg	150 lbs / 68 kg	ULTRA WHISPER 600	12V DC		34	102
						24V DC		17	51
						Phase Hz			
600	25 gal / 95 liters	155 lbs / 70 kg	150 lbs / 68 kg	Single 50 / 60	115	7.3 / 7.5	44 / 46		
				Single 50 / 60	230	3.5 / 3.7	22 / 23		

H.P. = Horse Power • NOA = Normal Operating Amps • SUC = Start Up Current

Dimensions

AQUA WHISPER MINI

COMPACT 170

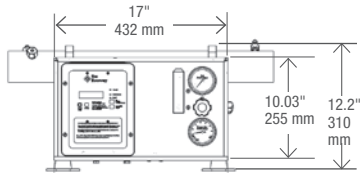

Front View

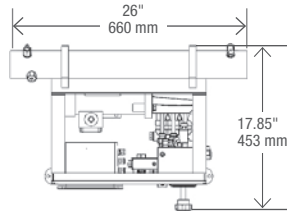

Top View

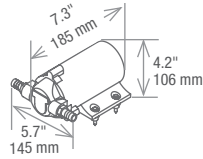

Booster Pump

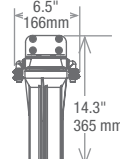

Single Pre/Post filter

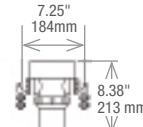

Sea Strainer

MODULAR

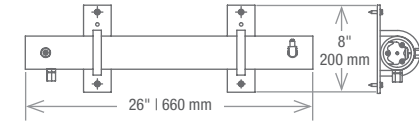

Membrane Assembly 170

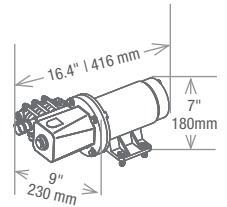

HP Pump (modular 170)

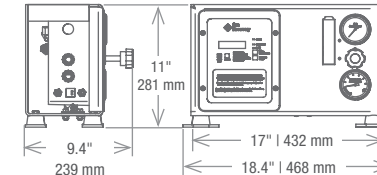

Control Panel (all models)

COMPACT 350, 550, and 750

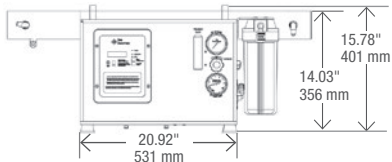

Front View

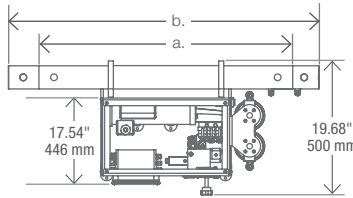

Top View

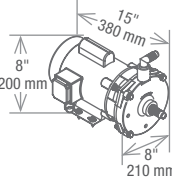

Booster Pump

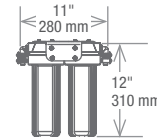

Prefilter Assembly

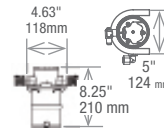

Sea Strainer

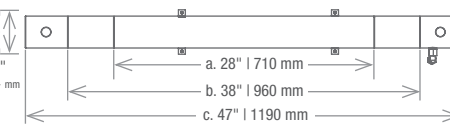

Membrane Assembly 350 - 750

a: AW Mini 350 | b: AW Mini 550 | c: AW Mini 750

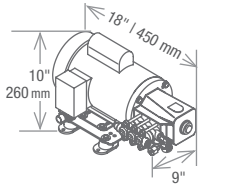

HP Pump

ULTRA WHISPER

COMPACT

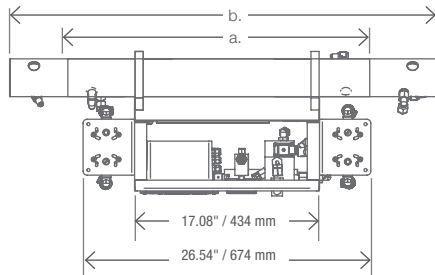

a. 37 15/16" - 964 mm: SRC Ultra Whisper Compact / Modular 200
b. 46 15/16" - 1192 mm: SRC Ultra Whisper Compact / Modular 400 & 600

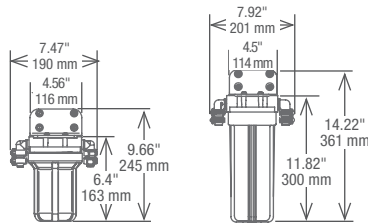

Sea Strainer

Single Pre/Post Filter

MODULAR

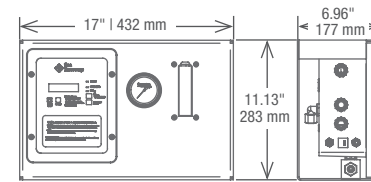

Control Panel

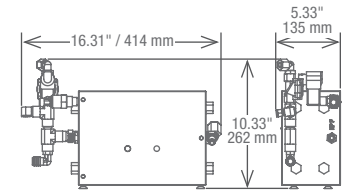

Energy Transfer Device

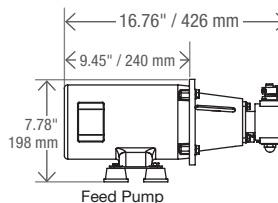

Feed Pump

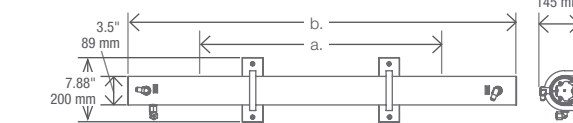

Single RO Membrane Assembly

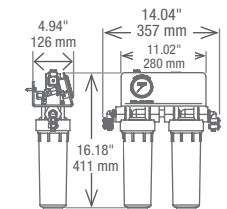

Dual Pre-Post filter

WATER CONNECTIONS: Feed Water 1/2" Brine Discharge 1/2" Product Water 1/4"

Coral Sea C-2

Never underestimate your fresh water needs

Sea Recovery creates the perfect watermaker for large yachts by combining industrial-strength production with space saving designs. Coral Sea systems are not only installed in luxury yachts, but are also regularly found on oil rigs and commercial vessels around the world. The system's durable construction is the reason why it easily crosses over to both industries. The Coral Sea is also user friendly, featuring electronic monitoring, an LCD touchscreen, and the latest in watermaking technology.

*Please refer to Sea Recovery's commercial brochure for larger systems.



Coral Sea Key Features

- Large-volume production, small footprint
- User-friendly color touchscreen
- Radial axial pump does not need oil change
- Optional automatic Media Filter

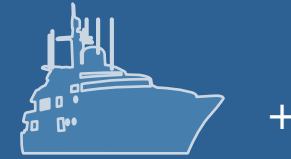

Category | Mega Yachts (over 80 ft / 24 m)

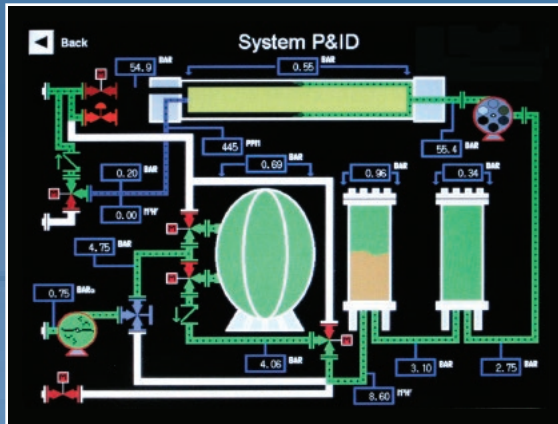

Rugged and reliable operation

The Coral Sea uses industrial PLC that is specifically designed to perform heavy duty operations. All functions are displayed on to the LCD touch screen and/or remote, allowing users to monitor and control the system from any location on the boat. With the Coral Sea, boaters are able produce water at any time and any place.

Functions that ensure your safety

The Coral Sea is one of the easiest and safest industrial grade watermakers to own. It features automatic operation and safety sensors, that when triggered, automatically shut down the system. To ensure safe operation, the Coral Sea will shut down when:

- pre-filter maintenance is required
- operating pressure limit is exceeded



Photo courtesy of Westport Yachts

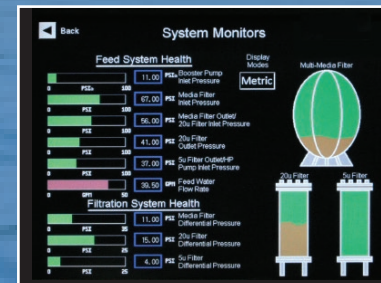

The Coral Sea's electronic meters also monitor important functions:

- fresh water flow
- brine discharge flow
- product water flow

Convenient configuration and design

Sea Recovery's membrane technology allows our watermakers to maximize the most space per gallon than any other systems on the market. The Coral Sea can produce up to 280 gallons an hour, and will fit in any large yacht with modular, horizontal, and vertical system configurations.

Specifications - Coral Sea C-2

	Model	No. of Vessels	Vessel Size	Production / Hour	Production / 24 Hrs.	Weight
PRODUCTION & WEIGHT	2800	4	3"	699 gal / 442 lit	2,799 gal / 10.59 m3	980 lbs / 445 kg
	3600	4	3"	899 gal / 568 lit	3,599 gal / 13.62 m3	980 lbs / 445 kg
	4200	3	4"	1,050 gal / 662 lit	4,200 gal / 15.89 m3	980 lbs / 445 kg
	5200	4	4"	1,299 gal / 820 lit	5,199 gal / 19.68 m3	1000 lbs / 454 kg
	6200	5	4"	1,549 gal / 978 lit	6,199 gal / 23.46 m3	1020 lbs / 463 kg
	6800	6	4"	1,699 gal / 1,073 lit	6,799 gal / 25.73 m3	1050 lbs / 477 kg

ELECTRICAL

Model 2800 - 3600			
Power	HP Pump	Booster	FLA
220/50 Hz/1PH	7.5	2	39
220/50 Hz/3 PH	7.5	2	27
230/60Hz/3PH	7.5	2	24
460/60Hz/3PH	7.5	2	12

Model 4200 - 6800			
Power	HP Pump	Booster	FLA
230/60Hz/1PH	N/A	N/A	N/A
208/60Hz/3PH	10	2	35
230/60Hz/3PH	10	2	31
460/60Hz/3PH	10	2	16

External Installation Water Connections	Feed Inlet	Clean Inlet	Brine Discharge	Clean Return	Product
2800 & 3600 ANSI Threaded Flange	3/4"	3/4"	3/4"	3/4"	1/2"
4200, 5200, 6200 & 6800 ANSI Threaded Flange	1"	1"	1"	1"	1/2"

Dimensions

Coral Sea C-2

VERTICAL

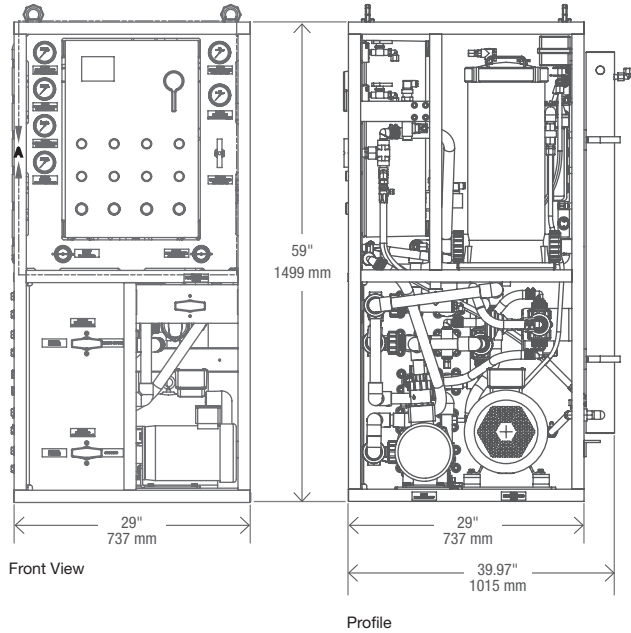

HORIZONTAL

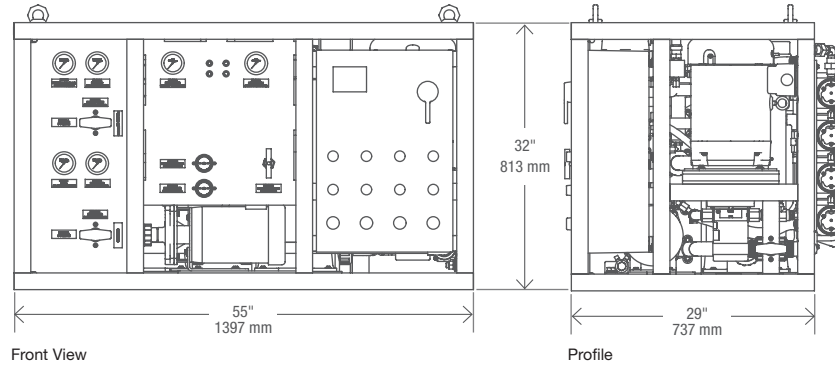

MODULAR

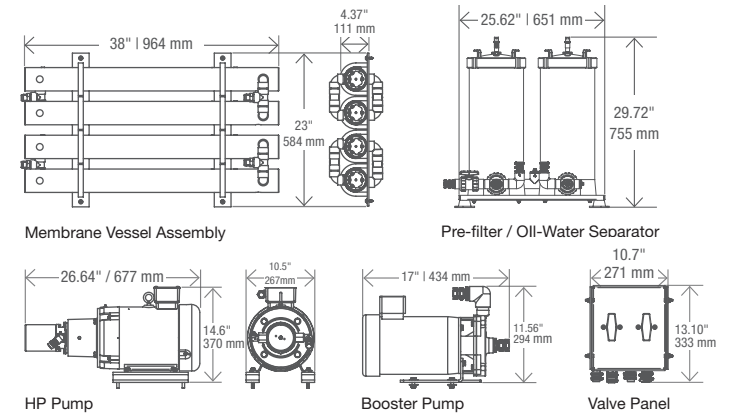
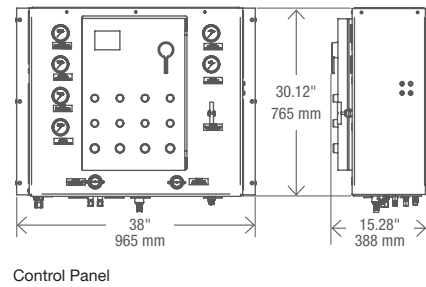

Coral Sea C-2 Accessories



UV Sterilizer
Eliminates 99.8 percent of bacteria and viruses from the feed water.



Fresh Water Flush
Prolong membrane life at the touch of a button.



Multi-Media Filter
Traps suspended solids larger than 30 microns to provide additional protection for the system's pre-filters, extending pre-filter element life. Please inquire for optional Automatic MMF



Chemical Injection
Control the chemistry of the feed water to reduce and prevent fouling.



pH Neutralizer
Provides pH neutralization of the reverse osmosis system product water.

* Refer to your owner's manual or visit www.searecovery.com for dimensions

Marine Accessories

KEY: ■ Aqua Matic ■ Aqua Whisper DX/PRO ■ Aqua Mini ■ Ultra Whisper

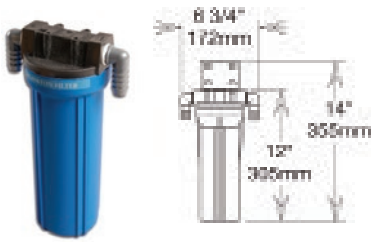

Plankton Filter

Filters most microorganisms from the feed water, prolonging pre-filter life.

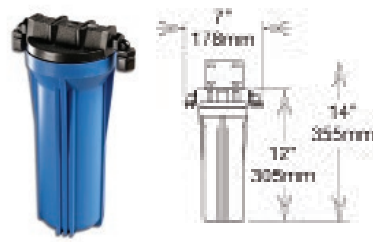

pH Neutralizer

Brings R.O. product water to a neutral pH.

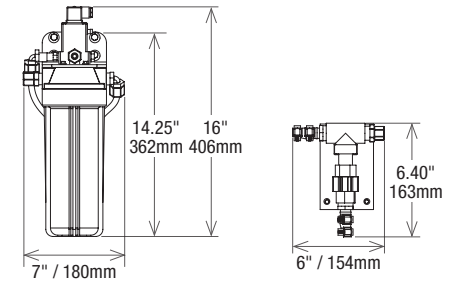

Fresh Water Flush

Prevents fouling of the membranes and pre-filters by automatically rinsing the system with fresh water every seven days.

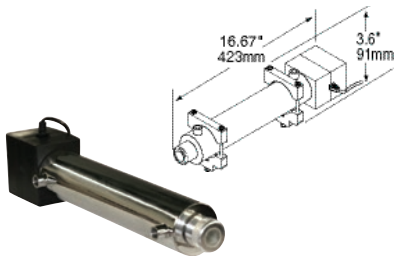

UV Sterilizer

Eliminates 99.8% of bacteria, viruses and microorganisms from the feed water.

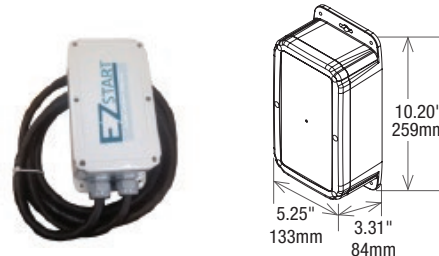

Soft Motor Start

Reduces system start up, up to 50%. It is only available for single phase, 11-/220VAC, 50/60 Hz systems.

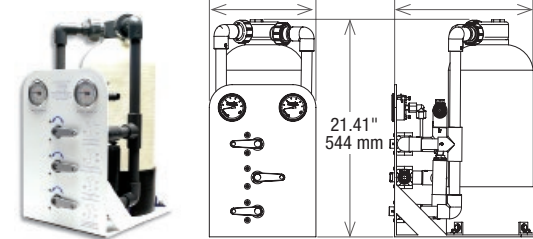

Multimedia Filter

Reduces pre-filter changes. Saves time and money. Recommended where feed water is high in suspended particles and biological growth (plankton).



Commercial Pre-filter & Oil / Water Separator

Recommended where feed water is high in suspended particles and biological growth (plankton).

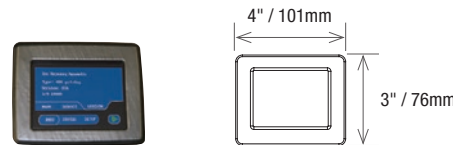

Touch Screen Remote

Operate your system from any location.



Push Button Remote

Operate your system from any location with this push button remote.



Consumables and Spares



Use Sea Recovery's genuine replacement consumables and spares in order to provide your watermaker with the highest quality material. Ensure the quality of your fresh water production by replacing filter and membrane elements. Our cleaning and storage compounds help prolong your watermaker, and eliminate unnecessary buildup that can lead to extra maintenance. Contact your dealer to order spare replacements.

All Sea Recovery Watermakers - General Specifications

Product Water Production Stated Per Hour And Per Day Of Operation

Based in $\pm 15\%$ at 800 psi / 55 Bar, 77°F / 25°C, 35,000 PPM TDS

Salt Rejection (Chloride Ion)

99.4%

Product Water Temperature

Ambient to feed water temperature

Salinity Monitoring

Automatic computer controlled electronic monitoring with continuous readout in micromhos per cubic centimeter, are temperature compensated and of a fail-safe design.

Salinity Range Of Feed Water

Seawater up to 50,000 PPM TDS (NaCl) (typically seawater salinity is 35,000 PPM TDS NaCl)

Temperature Range

Max. 122°F / 50°C Min. 33° F / .5°C

Reverse Osmosis Membrane

Specifically selected high rejection / high yield aromatic tri-polyamid, thin film composite, spiral wound, single pass reverse osmosis membrane element.

Chlorine Tolerance

1000 hours @ 0.1 PPM, pH range 3-11

Feed Water Pressure

Min 6 PSI / .42 Kg/cm² / 41.4kPa.

Max 40 PSI / 2.8 Kg/cm² / 275.8 kPa

Operating Pressure

From seawater @ 35,000 PPM & 77°F

Nominal 800 pSI / 56.25 Kg/cm² / 5516 kPa

For more information on systems and features, visit: www.searecovery.com



2630 E. El Presidio St., Carson, CA 90810
Toll Free: (855) 339-6899 • Tel: (310) 608-5600
Fax: (310) 608-5692 • Email: waterpurification@parker.com
Web: www.searecovery.com | www.parker.com/watermakers

Authorized dealer in your area

Sea Recovery Corporation cannot accept responsibility for possible errors in catalogs, brochures and other printed material. Sea Recovery Corporation reserves the right to alter its products without notice. This also applies to products already on order provided that such alterations can be made without subsequential changes being necessary in specifications already agreed.

PN: D1SMB • SRC04062015